

# Colour is our nature



## Connecting and configuring the LINEARdrive 100D/180D



A Removing the cover

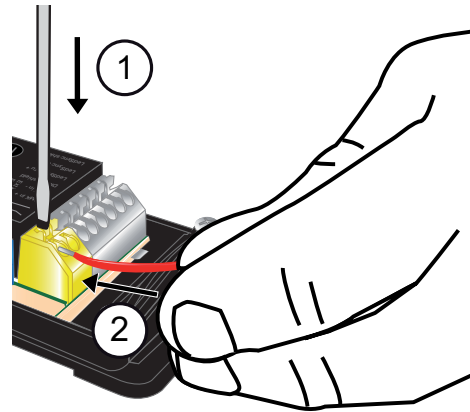

E Optional: Connecting external control device or network cabling



B Removing the strain reliefs



F Fastening the strain reliefs

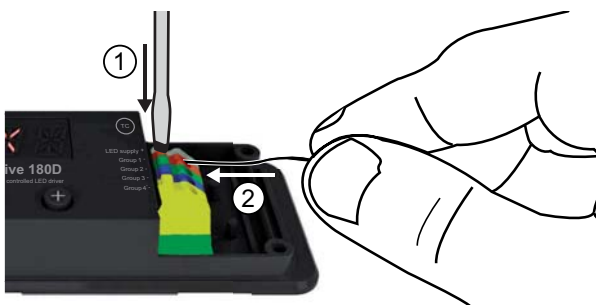

C Connecting LED wires

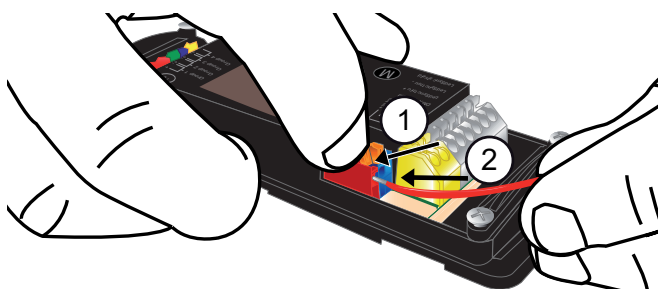

D Connecting power supply wires

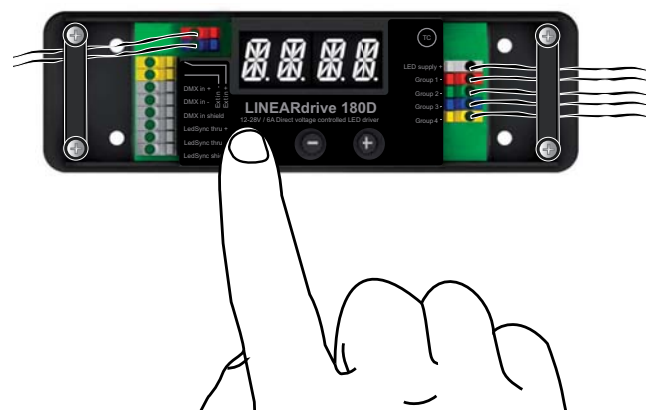

G Configuring the LINEARdrive DC

Manual configuration

1. Select mode of operation:

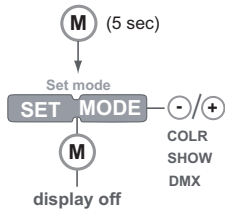

2. Set LED groups:

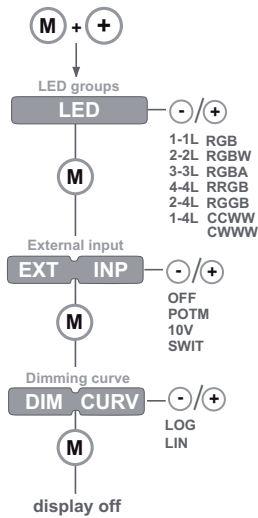

3. Standalone operation - Colour\*

or

Standalone operation - Show -

or

Networked operation - DMX -

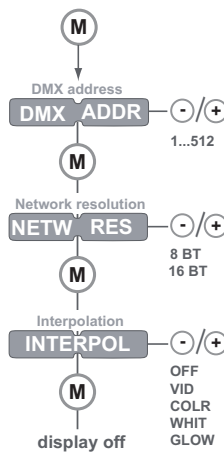
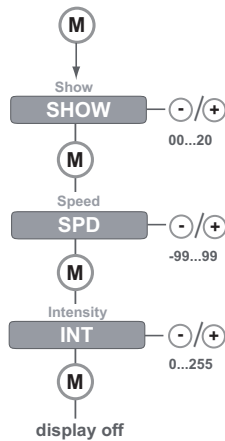
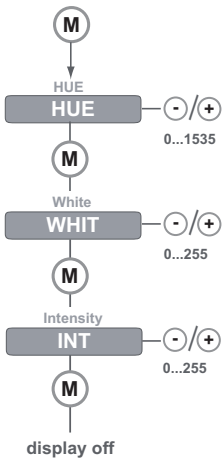

\* The colour menu depends on the LED group settings you have selected in step 2.

Other features

Visual test run

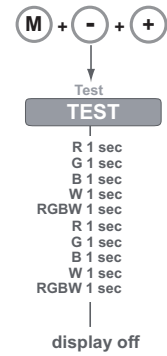

Locking the configuration:

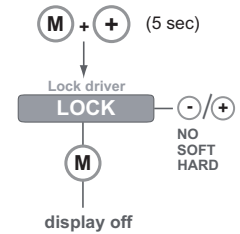

Reset to factory defaults

