

# Ultrasonic proximity sensors

# UNAM 50

**sample drawing**

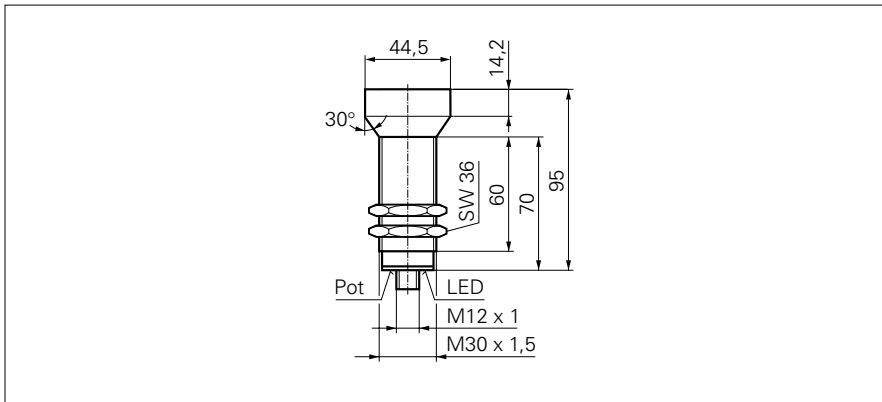

**general data**

scanning range Sd	350 ... 2500 mm
scanning range far limit Sde	350 ... 2500 mm
hysteresis typ.	4 % Sde
repeat accuracy	< 1 mm
synchronization	yes
temperature drift	< 0,18 % Sde/K
response time ton	< 160 ms
release time toff	< 160 ms
sonic frequency	120 kHz
adjustment	potentiometer
alignment aid	target indication flashing
output indicator	LED green

**electrical data**

voltage supply range +Vs	12 ... 30 VDC
current consumption max. (no load)	35 mA
output current	< 200 mA
voltage drop Vd	< 2 VDC
residual ripple	< 10 % Vs
short circuit protection	yes
reverse polarity protection	yes

**mechanical data**

type	cylindrical threaded
housing material	brass nickel plated
width / diameter	30 mm
height / length	95 mm

**ambient conditions**

operating temperature	-25 ... +60 °C
protection class	IP 67

**sample picture**



**Ultrasonic proximity sensors****UNAM 50**

<b>order reference</b>	<b>output circuit</b>	<b>connection types</b>
<b>UNAM 50N1721</b>	NPN make function (NO)	cable, 2 m
<b>UNAM 50N1721/S14</b>	NPN make function (NO)	connector M12
<b>UNAM 50N3721</b>	NPN break function (NC)	cable, 2 m
<b>UNAM 50N3721/S14</b>	NPN break function (NC)	connector M12
<b>UNAM 50P1721</b>	PNP make function (NO)	cable, 2 m
<b>UNAM 50P1721/S14</b>	PNP make function (NO)	connector M12
<b>UNAM 50P3721</b>	PNP break function (NC)	cable, 2 m
<b>UNAM 50P3721/S14</b>	PNP break function (NC)	connector M12