

Diffuse sensors with background suppression

OHDK 10 (Laser)

sample drawing

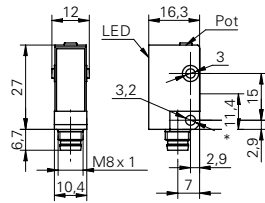

* emitter axis

general data

type	background suppression
light source	pulsed red laser diode
sensing distance Tw	22 ... 130 mm
sensing range Tb (at Tw max.)	3 ... 130 mm
sensing range Tb (at Tw min.)	3 ... 22 mm
repeat accuracy	< 0,2 mm at laser focus
power on indication	LED green
light indicator	LED yellow
sensing distance adjustment	mechanical, 5 turn
laser class	2
distance to focus	40 mm
wave length	650 nm
suppression of reciprocal influence	yes

electrical data

response time / release time	< 0,25 ms
voltage supply range +Vs	11 ... 30 VDC
current consumption max. (no load)	30 mA
current consumption typ.	25 mA
voltage drop Vd	< 1,8 VDC
output function	light / dark operate
short circuit protection	yes
reverse polarity protection	yes, supply only

mechanical data

width / diameter	10,4 mm
height / length	27 mm
depth	16,3 mm
type	rectangular
housing material	plastic (ASA)
front (optics)	PMMA

ambient conditions

operating temperature	-10 ... +50 °C
-----------------------	----------------

sample picture



laser warning



LASER RADIATION
DO NOT STARE INTO BEAM
Wavelength: 640...670nm
IEC 60825-1, Ed. 3, 2014
CLASS 2 LASER PRODUCT

Complies with 21 CFR 1040.10 and 1040.11 except for deviations pursuant to laser notice No. 50, dated June 24, 2007

**Diffuse sensors with
background suppression****OHDK 10 (Laser)**

order reference	connection types	output circuit	protection class	output current
OHDK 10N5101	cable 4 pin, 2 m	NPN	IP 65	< 70 mA
OHDK 10N5101/S35A	connector M8 4 pin	NPN	IP 67	< 70 mA
OHDK 10P5101	cable 4 pin, 2 m	PNP	IP 65	< 100 mA
OHDK 10P5101/S35A	connector M8 4 pin	PNP	IP 67	< 100 mA