

Through beam sensors

OEDK 10 (Laser, Receiver)

sample drawing

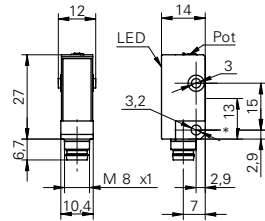

* receiver axis

general data

type	through beam laser sensor
emitter / receiver	receiver
actual range S_b	8 m
nominal range S_n	10 m
alignment / soiled lens indicator	flashing light indicator
light indicator	LED yellow
sensitivity adjustment	potentiometer, 270°

sample picture



electrical data

response time / release time	< 0,2 ms
voltage supply range +Vs	11 ... 30 VDC
current consumption max. (no load)	16 mA
current consumption typ.	16 mA
voltage drop Vd	< 1,8 VDC
output function	light / dark operate
output current	< 100 mA
short circuit protection	yes
reverse polarity protection	yes

mechanical data

width / diameter	10,4 mm
height / length	27 mm
depth	14 mm
type	rectangular
housing material	plastic (ASA)
front (optics)	PMMA

ambient conditions

operating temperature	-10 ... +50 °C
-----------------------	----------------

order reference	connection types	output circuit	protection class
OEDK 10N5105	cable 4 pin, 2 m	NPN	IP 65
OEDK 10N5105/S35A	connector M8 4 pin	NPN	IP 67
OEDK 10P5105	cable 4 pin, 2 m	PNP	IP 65
OEDK 10P5105/S35A	connector M8 4 pin	PNP	IP 67