

Diffuse sensors with background suppression

OHDM 16 (Laser)

sample drawing

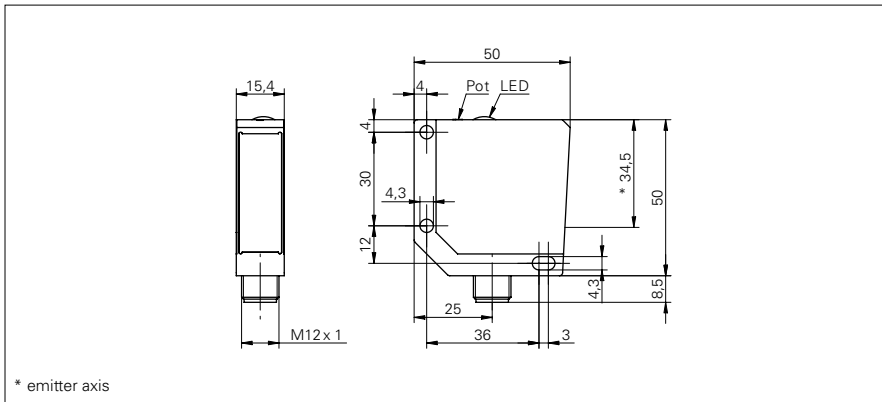

general data

type	background suppression
light source	pulsed red laser diode
sensing distance Tw	25 ... 300 mm
sensing range Tb (at Tw max.)	40 ... 300 mm
sensing range Tb (at Tw min.)	5 ... 25 mm
repeat accuracy	< 0,1 mm at laser focus
output indicator	LED yellow
sensing distance adjustment	mechanical, 8 turn
laser class	2
wave length	650 nm

electrical data

voltage supply range +Vs	10 ... 30 VDC
current consumption max. (no load)	35 mA
current consumption typ.	25 mA
voltage drop Vd	< 2 VDC
output function	light / dark operate
output current	< 200 mA
short circuit protection	yes
reverse polarity protection	yes

mechanical data

width / diameter	15,4 mm
height / length	50 mm
depth	50 mm
type	rectangular
housing material	die-cast zinc
front (optics)	glass

ambient conditions

operating temperature	-10 ... +50 °C
protection class	IP 67

sample picture



laser warning

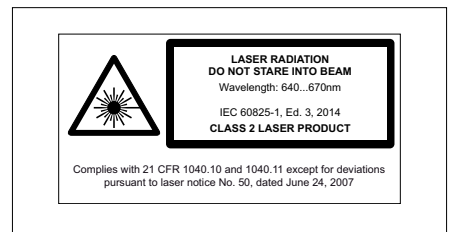

**Diffuse sensors with
background suppression**
OHDM 16 (Laser)

order reference	connection types	output circuit	response time / release time	distance to focus	suppression of reciprocal influence
OHDM 16N5001	cable 4 pin, 2 m	NPN	< 0,6 ms	80 mm	yes
OHDM 16N5001/S14	connector M12 4 pin	NPN	< 0,6 ms	80 mm	yes
OHDM 16P5001	cable 4 pin, 2 m	PNP	< 0,6 ms	80 mm	yes
OHDM 16P5001/S14	connector M12 4 pin	PNP	< 0,6 ms	80 mm	yes
OHDM 16P5002/S14	connector M12 4 pin	PNP	< 0,6 ms	40 mm	yes
OHDM 16P5012	cable 4 pin, 2 m	PNP	< 0,1 ms	60 mm	-
OHDM 16P5012/S14	connector M12 4 pin	PNP	< 0,1 ms	60 mm	-