

Diffuse contrast sensors

OZDK 10 (Laser line beam)

sample drawing

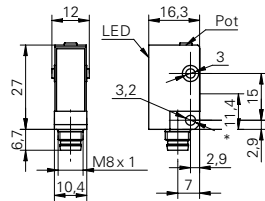

* emitter axis

general data

type	diffuse contrast sensor
version	line beam
light source	pulsed red laser diode
sensing distance Tw	3 ... 150 mm
optimum operating distance	35 ... 45 mm
repeat accuracy	< 0,2 mm at laser focus
power on indication	LED green
light indicator	LED yellow
sensitivity adjustment	potentiometer, 5 turn
laser class	1
distance to focus	40 mm
wave length	650 nm

electrical data

response time / release time	< 0,05 ms
voltage supply range +Vs	10 ... 30 VDC
current consumption max. (no load)	50 mA
current consumption typ.	40 mA
voltage drop Vd	< 1,8 VDC
output function	light / dark operate
output current	< 100 mA
short circuit protection	yes
reverse polarity protection	yes

mechanical data

width / diameter	10,4 mm
height / length	27 mm
depth	16,3 mm
type	rectangular
housing material	plastic (ASA)
front (optics)	PMMA

ambient conditions

operating temperature	-10 ... +50 °C
-----------------------	----------------

sample picture



laser warning

**CLASS 1 LASER
PRODUCT**

IEC 60825-1/2014
Complies with 21 CFR 1040.10 and 1040.11
except for deviations pursuant to laser
notice No. 50, dated June 24, 2007

Diffuse contrast sensors**OZDK 10 (Laser line beam)**

order reference	connection types	output circuit	protection class
OZDK 10N5150	cable 4 pin, 2 m	NPN	IP 65
OZDK 10N5150/S35A	connector M8 4 pin	NPN	IP 67
OZDK 10P5150	cable 4 pin, 2 m	PNP	IP 65
OZDK 10P5150/S35A	connector M8 4 pin	PNP	IP 67