

Diffuse sensors with intensity difference

OZDK 10 (Laser line beam)

sample drawing

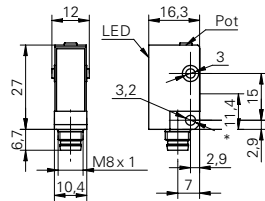

* emitter axis

general data

| | |
|----------------------------|-------------------------|
| type | intensity difference |
| version | line beam |
| light source | pulsed red laser diode |
| sensing distance Tw | 3 ... 150 mm |
| optimum operating distance | 35 ... 45 mm |
| repeat accuracy | < 0,2 mm at laser focus |
| power on indication | LED green |
| light indicator | LED yellow |
| sensitivity adjustment | potentiometer, 5 turn |
| laser class | 1 |
| distance to focus | 40 mm |
| wave length | 650 nm |

electrical data

| | |
|------------------------------------|----------------------|
| response time / release time | < 0,05 ms |
| voltage supply range +Vs | 10 ... 30 VDC |
| current consumption max. (no load) | 50 mA |
| current consumption typ. | 40 mA |
| voltage drop Vd | < 1,8 VDC |
| output function | light / dark operate |
| output current | < 100 mA |
| short circuit protection | yes |
| reverse polarity protection | yes |

mechanical data

| | |
|------------------|---------------|
| width / diameter | 10,4 mm |
| height / length | 27 mm |
| depth | 16,3 mm |
| type | rectangular |
| housing material | plastic (ASA) |
| front (optics) | PMMA |

ambient conditions

| | |
|-----------------------|----------------|
| operating temperature | -10 ... +50 °C |
|-----------------------|----------------|

sample picture



laser warning

CLASS 1 LASER PRODUCT

IEC 60825-1/2014
Complies with 21 CFR 1040.10 and 1040.11
except for deviations pursuant to laser
notice No. 50, dated June 24, 2007

**Diffuse sensors with
intensity difference****OZDK 10 (Laser line beam)**

| order reference | connection types | output circuit | protection class |
|--------------------------|-------------------------|-----------------------|-------------------------|
| OZDK 10N5150 | cable 4 pin, 2 m | NPN | IP 65 |
| OZDK 10N5150/S35A | connector M8 4 pin | NPN | IP 67 |
| OZDK 10P5150 | cable 4 pin, 2 m | PNP | IP 65 |
| OZDK 10P5150/S35A | connector M8 4 pin | PNP | IP 67 |