

**Diffuse contrast sensors**

**OZDK 10 (Laser)**

**sample drawing**

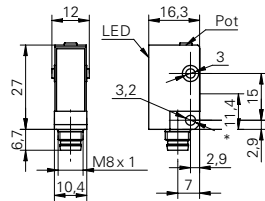

\* emitter axis

**general data**

type	diffuse contrast sensor
light source	pulsed red laser diode
sensing distance Tw	3 ... 150 mm
optimum operating distance	20 ... 40 mm
detectable remission difference (on grey)	> 8 %
repeat accuracy	< 0,2 mm at laser focus
power on indication	LED green
light indicator	LED yellow
sensitivity adjustment	potentiometer, 5 turn
laser class	2
distance to focus	40 mm
wave length	650 nm

**electrical data**

response time / release time	< 0,05 ms
voltage supply range +Vs	10 ... 30 VDC
current consumption max. (no load)	50 mA
current consumption typ.	40 mA
voltage drop Vd	< 1,8 VDC
output function	light / dark operate
output current	< 100 mA
short circuit protection	yes
reverse polarity protection	yes

**mechanical data**

width / diameter	10,4 mm
height / length	27 mm
depth	16,3 mm
type	rectangular
housing material	plastic (ASA)
front (optics)	PMMA

**ambient conditions**

operating temperature	-10 ... +50 °C
-----------------------	----------------

**sample picture**



**laser warning**

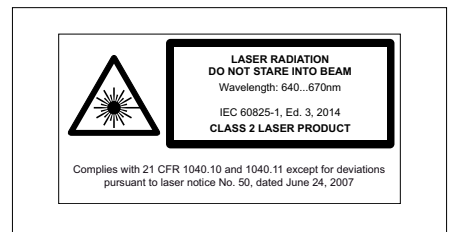

**Diffuse contrast sensors****OZDK 10 (Laser)**

<b>order reference</b>	<b>connection types</b>	<b>output circuit</b>	<b>protection class</b>
<b>OZDK 10N5101</b>	cable 4 pin, 2 m	NPN	IP 65
<b>OZDK 10N5101/S35A</b>	connector M8 4 pin	NPN	IP 67
<b>OZDK 10P5101</b>	cable 4 pin, 2 m	PNP	IP 65
<b>OZDK 10P5101/S35A</b>	connector M8 4 pin	PNP	IP 67