

Accessories

Connectors and cables

Mating



Description

Mating connector M23 (17-pin, 11 pins assigned, female, CCW) for cable connection to the flange connector M23 (17-pin, male, CW) with connected sensor cable HEK 17, length 5 m.

The sensor cable HEK 17 is a proven industrial product designed to match high demands. It is halogen free, oil-resistant, abrasion and notch-resistant and its rugged outer construction allows it to be pulled and dragged in free conditions. It is certified to UL AWM Style 20236, CSA AWM IA/B; IIA/B FT 1, UL File No. E63634.

Part number

11172499 Mating connector M23 (11 pins assigned)
17-pin, CCW with sensor cable
HEK 17, length 5 m

Suitable for

HMG10-B - SSI, PMG10 - SSI

Technical data

Sensor cable HEK 17

| | |
|-----------------------|---|
| Signal wires | 3 twisted pair signal wires AWG35 4 wires AWG35 4 wires AWG31 |
| Power wires | 2 wires AWG21 |
| Shield | Common low capacity shield Paired signal wires shielded |
| Nominal voltage | IEC: 30 V UL & CSA: 30 V |
| Test voltage | Wire/wire: 1500 V eff Wire/shield: 750 V eff |
| Operating temperature | Flexing: -40...+90 °C (UL/CSA: +80 °C) Fixed installation: -50...+90 °C (UL/CSA: +80 °C) |
| Bending radius | Flexible use: ≥7,5 x outside diameter Fixed installation: ≥4 x outside diameter |
| Outside diameter | 9.4 mm |
| Colour | DESINA-green (RAL 6018) |
| Weight approx. | 110 g/m |
| Approvals | UL AWM Style 20236 CSA AWM IA/B; IIA/B FT 1 UL File No. E63634 |

Accessories

Connectors and cables

Mating

Dimensions

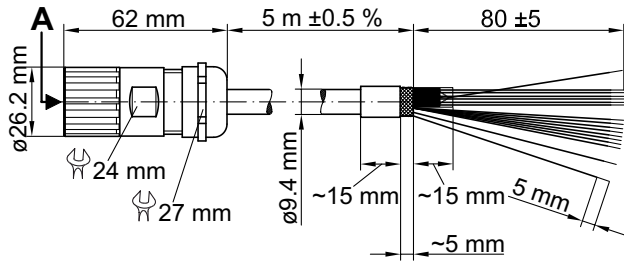

Terminal assignment

View A - Mating connector M23, 17-pin (11 pins assigned), female, CCW with sensor cable HEK 17

| Buchse | Wire colour | Wire cross-section |
|--------|--------------|----------------------|
| 1 | Not assigned | --- |
| 2 | White/Yellow | 0,14 mm ² |
| 3 | Black | 0,14 mm ² |
| 4 | Not assigned | --- |
| 5 | White/Black | 0,14 mm ² |
| 6 | Brown | 0,14 mm ² |
| 7 | Brown/Red | 0,5 mm ² |
| 8 | Green/Red | 0,22 mm ² |
| 9 | Green/Black | 0,22 mm ² |
| 10 | Brown/Blue | 0,5 mm ² |
| 11* | Black | 0,5 mm ² |
| 12 | Not assigned | --- |
| 13 | Not assigned | --- |
| 14 | Brown/Yellow | 0,22 mm ² |
| 15 | Not assigned | --- |
| 16 | Not assigned | --- |
| 17 | Brown/Green | 0,22 mm ² |

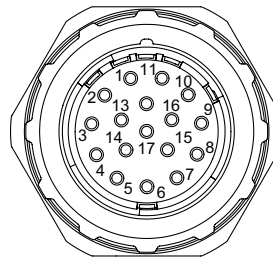

* Internal shield, connected with all internal shields