

Quick Start Guide  
VEXU cameras (USB 3.0)

Latest software version and technical documentation available at:  
[vt.baumer.com](http://vt.baumer.com)

## Product Specification

### VEXU cameras – Integrating essential basic functionalities

- up to 2.3 Megapixel
- up to 217 fps
- 29 x 29 mm housing with all-sided M3 mount
- Global shutter architecture for minimized motion blur
- Integrating essential basic functionalities
- USB bus powered
- USB Vision™ standard compliant

**Notice**  
Further technical details are available in the respective data sheets.

## Dimensions

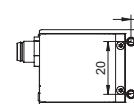
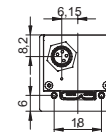
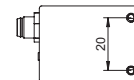
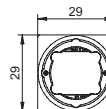
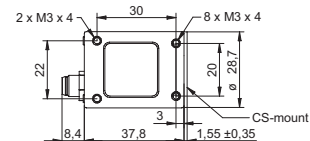

## Safety

Conformity:  
CE, RoHS



CE

We declare, under our sole responsibility, that the previously described Baumer VEXU cameras conform with the directives of the CE.

RoHS

All VEXU cameras comply with the recommendation of the European Union concerning RoHS Rules.

### Safety Precautions

**Notice**  
See the User's Guide for the complete safety instructions!

**Caution**  
Observe precautions for handling electrostatically sensitive devices!

- Protect the sensor from dirt and moisture.
- Do not allow the camera to become contaminated with foreign objects.

### Environmental Requirements

Storage temp.	-10° C ... +70° C
Operating temp.	see Heat Transmission
Humidity	10 % ... 90 % Non-condensing

### Further Information

For further information about our products, please visit [www.baumer.com](http://www.baumer.com)  
For technical issues, please contact our technical support:  
[support.cameras@baumer.com](mailto:support.cameras@baumer.com) · Phone +49 (0)3528 4386-845 · Fax +49 (0)3528 4386-86

© Baumer Optronic GmbH · Badstrasse 30 · DE-01454 Radeberg, Germany

Technical data has been fully checked, but accuracy of printed matter is not guaranteed.  
The information in this document is subject to change without notice.

## System Requirements

	Single-camera system Recommended	Multi-camera system Recommended
CPU	Intel® Core™ i5-2520M CPU @ 2.50 GHz, Cores: 4	Intel® Core™ i7-3770 CPU @ 3.40 GHz, Cores: 8
RAM	4 GB	8 GB
Operating system	Microsoft® Windows® 7 32 / 64 bit systems (required for USB 3.0) Microsoft® Windows® 8 32 / 64 bit systems (required for USB 3.0)	Microsoft® Windows® 10 32 / 64 bit systems (required for USB 3.0)
(OS)	Microsoft® Windows® 10 32 / 64 bit systems (required for USB 3.0)	

## Installation

### Lens Mount

**Notice**  
Ensure the sensor and lens are not contaminated with dust and airborne particles when mounting the support or the lens to the device!

The following points are very important:

- Install the camera in an environment that is as dust free as possible!
- Keep the dust cover (bag) on the camera for as long as possible!
- Hold the camera with the sensor downwards if the sensor is uncovered.
- Avoid contact with any of the camera's optical surfaces!

## General Description

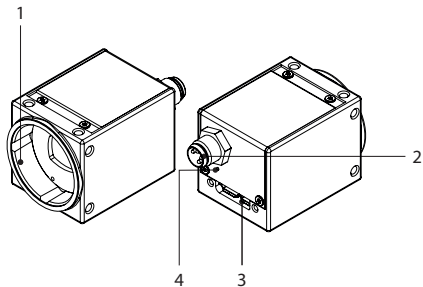

No.	Description	No.	Description
1	Lens mount (CS-mount)	4	LED
2	Digital IO		
3	USB 3.0 port		

## Data Interface / Digital IOs

### USB 3.0 (Micro B)



1	VBUS	6	MicB_SSTX-
2	D-	7	MicB_SSTX+
3	D+	8	GND_DRAIN
4	ID	9	MicB_SSRX-
5	GND	10	MicB_SSRX+

### Digital-IOs (on camera side) wire colors of the connecting cable (ordered separately)



1	Power IO	brown	3	GND	blue
2	IN1 (Line0)	white	4	OUT1 (Line1)	black

## LED signals

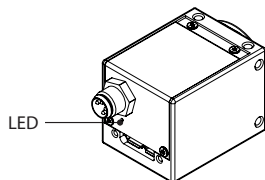

	Signal	Meaning
LED	green flash	Power on
	green	USB 3.0 connection
	red	USB 2.0 connection
	yellow	Readout active
	red flash	Update

## Installation

### Installing the camera:

- Connect the camera to the USB connection on your PC using an appropriate cable.
- If required, connect a trigger and / or flash to the digital IOs.

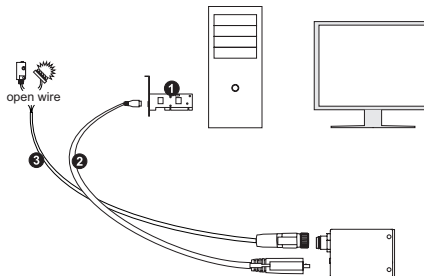

Installation example  
 1 - PCI USB board  
 2 - USB cable  
 3 - Cable for trigger and flash

## Heat Transmission

### Caution

Heat can damage the camera. Heat must be dissipated adequately to ensure that the temperature does not exceed the values in the table below.



As there are numerous possibilities for installation, Baumer recommends no specific method for proper heat dissipation, but suggest the following principles:

- operate the cameras only in mounted condition
- mounting in combination with forced convection may provide proper heat dissipation

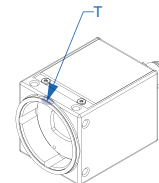

Measurement Point	Maximum Temperature
Measurement Point (T)	65°C (149°F)

## Troubleshooting

1. Check camera operation using the LED signals.

→ If LED is red:

- Camera is connected to USB 2.0 (settings possible).

2. Check connection using Windows Device Manager:

→ If device is not listed:

- Check the host controller power supply.
- Check USB 3.0 cable and connection.

→ If device is regularly not listed

- Check USB 3.0 driver installation.