

**overview**

- 4096 × 3000 px
- Sony IMX253
- 1.1" CMOS
- 69 fps
- 10 GigE
- available



**technical data**

**sensor information**

|               |                    |
|---------------|--------------------|
| sensor        | Sony IMX253        |
| resolution    | 4096 × 3000 px     |
| exposure time | 0,001 ... 60000 ms |
| pixel size    | 3.45 × 3.45 µm     |
| shutter type  | Global shutter     |
| sensor type   | 1.1" CMOS          |

**acquisition formats**

|   |  |
|---|--|
| image formats, interface frame rate max.                | Full Frame, 4096 × 3000 px, max. 69 fps<br>Binning 2×2, 2048 × 1500 px, max. 135 fps<br>Binning 2×1, 2048 × 3000 px, max. 69 fps<br>Binning 1×2, 4096 × 1500 px, max. 69 fps |
| image formats, acquisition frame rate max. (Burst Mode) | Full Frame, 4096 × 3000 px, max. 69 fps  |
| pixel formats   | Mono8<br>Mono10<br>Mono12<br>Mono12 Packed   |

image formats, acquisition frame rate max. (Burst Mode)

pixel formats  
Mono8  
Mono10  
Mono12  
Mono12 Packed

**image preprocessing**

analog controls  
Gain (0 ... 48 dB)  
Offset (0 ... 255 LSB 12 Bit)

color models  
Mono

**camera features**

synchronization  
free running trigger

**camera features**

|                       |  |
|-----------------------|--|
| trigger sources       | Hardware<br>software<br>ActionCommand                              |
| trigger delay         | 0 ... 2 sec, tracking and buffering of up to 256 trigger signals   |
| internal image buffer | 1024 MB<br>78 images (Trigger Mode)<br>1 image (Free Running Mode) |

**interfaces and connectors**

|                   |  |
|-------------------|--|
| data interface    | 10 Gigabit Ethernet, Transfer rate 10000 Mbits/sec, Gigabit Ethernet, Transfer rate 1000 Mbits/sec, Fast Ethernet, Transfer rate 100 Mbits/sec, Connector: M12 / 8-pol x-coded (SACC-CI-M12FS-8CON-L180-10G) |
| process interface | M12 / 12 pins a-coded (SACC-CI-M12MS-12CON-L180)   |
| power supply      | via M12/12 pins a-coded  |

**mechanical data**

|            |          |
|------------|----------|
| lens mount | C-mount  |
| width      | 60 mm    |
| height     | 60 mm    |
| depth      | 99,7 mm  |
| weight     | ≤ 485 g  |
| material   | aluminum |

**electrical data**

|                          |  |
|--------------------------|--|
| voltage supply range +Vs | 12 ... 24 V DC (external power supply) |
| power consumption        | approx. 10,5 W @ 12 VDC and 69 fps     |

**technical data**

**non-volatile memory**

flash memory size 128 kB

**environmental conditions**

operating temperature 0 ... +65 ° @ T = measurement point

humidity 10 ... 90 % (non-condensing)

protection class IP 40  
IP 54 (with mounted tube and cable)  
IP 65 (with mounted tube and cable)  
IP 67 (with mounted tube and cable)

**digital I/Os**

lines 2 input lines  
4 output lines with pulse width modulation (PWM) (max. 48 V / max. 2,5 A)  
RS232

**conformity**

conformity CE  
RoHS  
EAC

**dimension drawing**

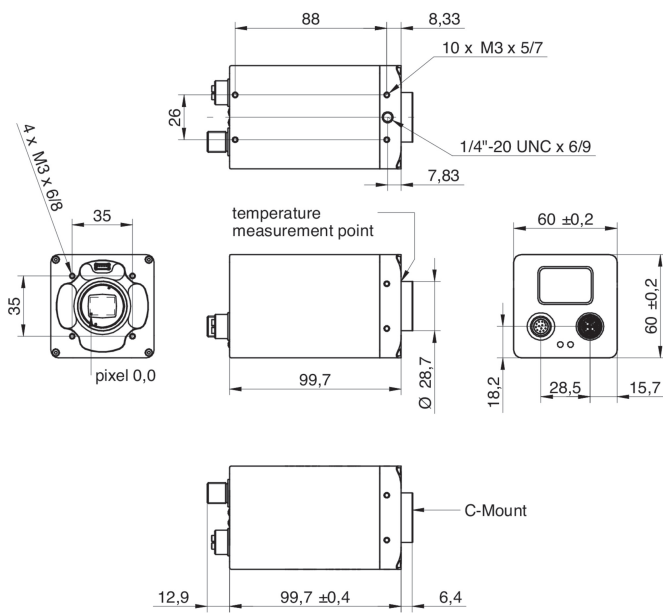

**Principle**

Optional accessories for protection class IP65/67:

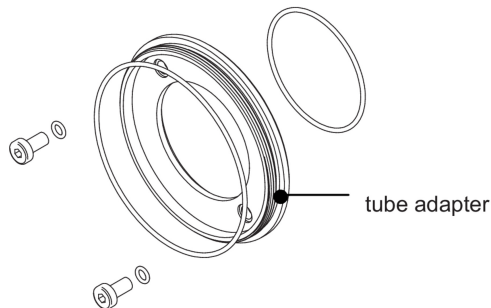

- tube adapter
- Ø 49,5 mm, hard-anodized, incl. sealing and screws (VCXG.I 11185373)
  - Ø 65 mm, hard-anodized, incl. sealing and screws (VCXG.I 11185377; VLXT 11193125)

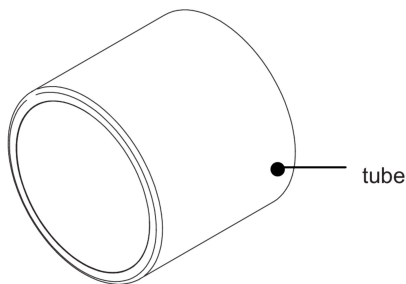

- tube
- Ø 49,5 mm, length 44 mm, hard-anodized, cover glass PMMA (11185370)
  - Ø 65 mm, length 58 mm, hard-anodized, cover glass PMMA (11185374)
  - Ø 49,5 mm, length 44 mm, hard-anodized, tempered laminated safety glass (11195425)
  - Ø 65 mm, length 58 mm, hard-anodized, tempered laminated safety glass (11195426)

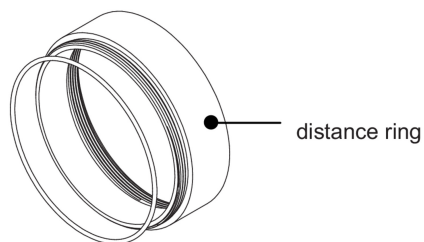

- distance ring
- Ø 49,5 mm, length 12 mm, hard-anodized, incl. sealing (11185371)
  - Ø 49,5 mm, length 6 mm, hard-anodized, incl. sealing (11185372)
  - Ø 65 mm, length 12 mm, hard-anodized, incl. sealing (11185375)
  - Ø 65 mm, length 6 mm, hard-anodized, incl. sealing (11185376)
  - Ø 65 mm, length 36 mm, hard-anodized, incl. sealing (111988906)