

Diffuse sensors with background suppression

OHDK 10N5101/S35A

dimension drawing

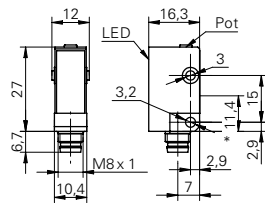

* emitter axis

general data

| | |
|-------------------------------------|-------------------------|
| type | background suppression |
| light source | pulsed red laser diode |
| sensing distance T_w | 22 ... 130 mm |
| sensing range T_b (at T_w max.) | 3 ... 130 mm |
| sensing range T_b (at T_w min.) | 3 ... 22 mm |
| repeat accuracy | < 0,2 mm at laser focus |
| power on indication | LED green |
| light indicator | LED yellow |
| sensing distance adjustment | mechanical, 5 turn |
| laser class | 2 |
| distance to focus | 40 mm |
| wave length | 650 nm |
| suppression of reciprocal influence | yes |

photo



electrical data

| | |
|------------------------------------|----------------------|
| response time / release time | < 0,25 ms |
| voltage supply range +Vs | 11 ... 30 VDC |
| current consumption max. (no load) | 30 mA |
| current consumption typ. | 25 mA |
| voltage drop V_d | < 1,8 VDC |
| output function | light / dark operate |
| output circuit | NPN |
| output current | < 70 mA |
| short circuit protection | yes |
| reverse polarity protection | yes, supply only |

connection diagram

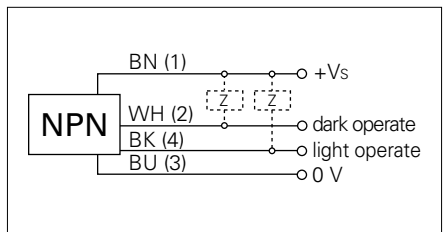

laser warning

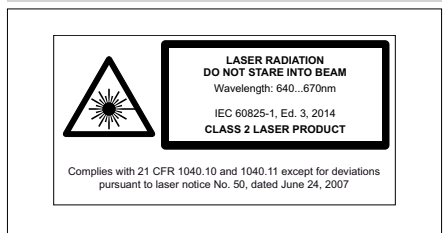

mechanical data

| | |
|------------------|--------------------|
| width / diameter | 10,4 mm |
| height / length | 27 mm |
| depth | 16,3 mm |
| type | rectangular |
| housing material | plastic (ASA) |
| front (optics) | PMMA |
| connection types | connector M8 4 pin |



Diffuse sensors with background suppression

OHDK 10N5101/S35A

ambient conditions

| | |
|-----------------------|----------------|
| operating temperature | -10 ... +50 °C |
| protection class | IP 67 |