

Accessories

Mounting accessories

Mounting kit 050



Features

- For low-dynamic applications and constant movements

Description

Torque support onto encoder by help of the attached screws. Push encoder onto the drive shaft and mount torque support onto the client side. Fastening clamping ring by the screw provided.

Part number

11066073 Mounting kit 050

Scope of delivery

Included:
torque support, two screws M3 x 12 (DIN 7985 - TX10) with two spacers 7 mm

Dimensions

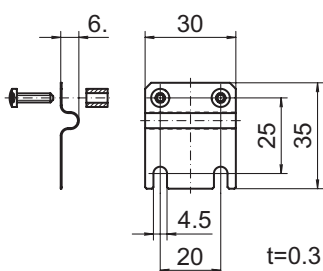

Z00422

Assembly drawing

