

**Overview**

- ATEX version of TED hygienic
- -1 ... 0 bar up to 0 ... 25 bar
- Robust stainless steel housing for severe industrial environments
- Two threshold outputs (PNP transistors)



**Technical data**

**Performance characteristics**

Pressure type	Absolute Relative (gauged)
Long term stability	≤ 0.2 % FSR/a
Max. measuring error	≤ 0.5 % FSR Including zero-point and span error, non-linearity (by terminal base line), hysteresis and non-repeatability (EN 61298-2)
Max. measuring span	25 bar
Measuring range	-1 ... 25 bar
Standard error of measurement (BFSL)	± 0.3 % FSR Including non-linearity, hysteresis and non-repeatability according BFSL
Threshold setting range	2 ... 98 % FSR
Min. measuring span	1 bar
Rise time (10 ... 90 %)	≤ 20 ms
Temperature coefficient	≤ 0.15 % FSR/10 K

**Process conditions**

Process pressure	Refer to section "Process conditions"
Process temperature	-25 ... 100 °C

**Process connection**

Connection variants	Refer to section "Dimensional drawings"
Wetted parts material, membrane	AISI 316L (1.4404)
Wetted parts material, process connection	AISI 316L (1.4404)

**Ambient conditions**

Shock (EN 60068-2-27)	25 falls from 1 m onto concrete floor
Vibration (sinusoidal) (EN 60068-2-6)	1.5 mm p-p (10 ... 58 Hz), 20 g (58 Hz ... 2 kHz)
Degree of protection (EN 60529)	IP 67

**Ambient conditions**

Operating temperature range	-25 ... 85 °C
Storage temperature range	-40 ... 85 °C

**Output signal**

Load resistance	$R_s \leq (V_s - 10 V)/0.02 A$ , with 2-wire
Current output	4 ... 20 mA, 2-wire
Output signal	2 switching points

**Housing**

Overall size	Refer to section "Dimensional drawings"
Style	Compact transmitter
Material	AISI 304 (1.4301)

**Electrical connection**

Connector	M12-A, 5-pin
-----------	--------------

**Power supply**

Voltage supply range	10 ... 28 V DC
----------------------	----------------

**ATEX II 1G Ex ia IIC T5/T6**

Maximum values for barrier selection, $U_i$	≤ 28 V
Maximum values for barrier selection, $I_i$	≤ 120 mA
Maximum values for barrier selection, $P_i$	≤ 800 mW
Internal capacitance, $C_i$	≤ 13.2 nF
Internal inductance, $L_i$	≤ 0 μH
Temperature class, T1 ... T5	-25 < Tamb < 70 °C
Temperature class, T1 ... T6	-25 < Tamb < 40 °C

**Compliance and approvals**

EMC	EN 61000-6-2 EN 61000-6-3 EN 61326-1
-----	--

# YTED hygienic

Hygienic pressure switch

YTED-##.5.###.#

## Operating conditions

Measuring range (bar)		Proof pressure (bar)	Burst Pressure (bar)
-1 ... 0	-1 ... 0,6	3	6
	0 ... 1	3	7
	0 ... 1,6	3	7
	-1 ... 1,5	4	7
	0 ... 2,5	4	7
	-1 ... 3	8	12
	0 ... 4	8	12
	-1 ... 5	12	18
	0 ... 6	12	18
	-1 ... 9	20	30
	0 ... 10	20	30
	-1 ... 15	32	48
	0 ... 16	32	48
	-1 ... 24	50	75
	0 ... 25	50	75

## Dimensional drawings

### Housing

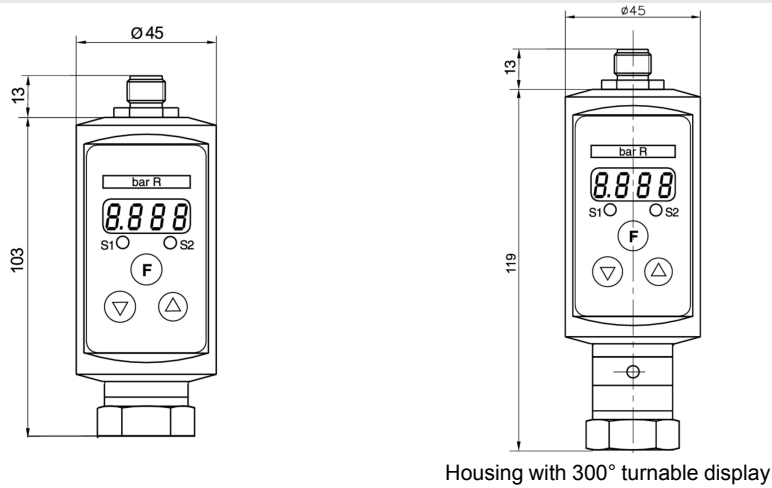

## Process connection

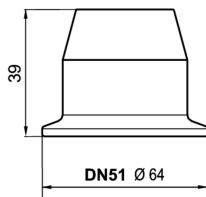

ISO 2852 (Tri-Clamp), DN 51, Ø 64.0 (BCID: C05)

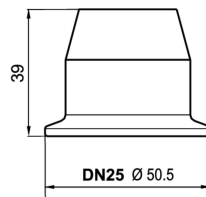

ISO 2852 (Tri-Clamp), DN 38, Ø 50.5 (BCID: C04)

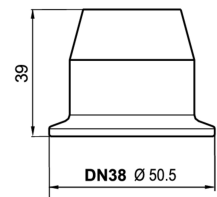

ISO 2852 (Tri-Clamp), DN 25, Ø 50.5 (BCID: C03)

# YTED hygienic

Hygienic pressure switch

YTED-##.5.###.#

## Electrical connection

Version	Equivalent circuit	Electrical connection	Function	Pin assignment										
YTED-##.###.#			<table border="1"> <tr><td>+Vs</td><td>1</td></tr> <tr><td>lout</td><td>3</td></tr> <tr><td>SW1</td><td>4</td></tr> <tr><td>SW2</td><td>2</td></tr> <tr><td>GND (0 V)</td><td>5</td></tr> </table>	+Vs	1	lout	3	SW1	4	SW2	2	GND (0 V)	5	
+Vs	1													
lout	3													
SW1	4													
SW2	2													
GND (0 V)	5													

## Ordering information

Ordering key - Configuration possibilities see website

YTED - ## . 5 . ### . # #### 2037

<b>Product</b>	YTED				
<b>Process connection</b>					
CLAMP ISO DN 51		11			
CLAMP ISO DN 25		15			
CLAMP ISO DN 38		18			
<b>Sealing</b>					
EPDM			5		
<b>Measuring range</b>					
0...1 bar (EN)					B15
0...1,6 bar (EN)					B16
0 ... 2.5 bar (EN)					B18
0 ... 4 bar (EN)					B19
-1...39 bar (EN)					B1L
0 ... 6 bar (EN)					B20
0 ... 10 bar (EN)					B22
0 ... 16 bar (EN)					B24
0...25 bar (EN)					B26
-1...0 bar (EN)					B59
-1...0,6 bar (EN)					B72
-1...1,5 bar (EN)					B74
-1...3 bar (EN)					B76
-1...5 bar (EN)					B77
-1...9 bar (EN)					B79
-1...15 bar (EN)					B81
-1...24 bar (EN)					B82
0...100 kPa (EN)					D15
0...160 kPa (EN)					D16
0...250 kPa (EN)					D18
0...400 kPa (EN)					D19
-100...3900 kPa (EN)					D1L
0...600 kPa (EN)					D20
0...1000 kPa (EN)					D22
0...1600 kPa (EN)					D24
0...2500 kPa (EN)					D26
-100...0 kPa (EN)					D59

# YTED hygienic

Hygienic pressure switch

YTED-##.5.###.#

## Ordering information

**Ordering key - Configuration possibilities see website**

YTED - ## . 5 . ### . # ### 2037

-100...60 kPa (EN)	D72
-100...150 kPa (EN)	D74
-100...300 kPa (EN)	D76
-100...500 kPa (EN)	D77
-100...900 kPa (EN)	D79
-100...1500 kPa (EN)	D81
-100...2400 kPa (EN)	D82
0...1 kg/cm <sup>2</sup> (EN)	F15
0...1,6 kg/cm <sup>2</sup> (EN)	F16
0...2,5 kg/cm <sup>2</sup> (EN)	F18
0...4 kg/cm <sup>2</sup> (EN)	F19
-1...39 kg/cm <sup>2</sup>	F1L
0...6 kg/cm <sup>2</sup> (EN)	F20
0...10 kg/cm <sup>2</sup> (EN)	F22
0...16 kg/cm <sup>2</sup> (EN)	F24
0...25 kg/cm <sup>2</sup> (EN)	F26
-1...0 kg/cm <sup>2</sup> (EN)	F59
-1...0,6 kg/cm <sup>2</sup> (EN)	F72
-1...1,5 kg/cm <sup>2</sup> (EN)	F74
-1...3 kg/cm <sup>2</sup> (EN)	F76
-1...5 kg/cm <sup>2</sup> (EN)	F77
-1...9 kg/cm <sup>2</sup> (EN)	F79
-1...15 kg/cm <sup>2</sup> (EN)	F81
-1...24 kg/cm <sup>2</sup> (EN)	F82
0...15 psi (ANSI)	H15
0...30 psi (ANSI)	H17
0...60 psi (ANSI)	H19
0...20 psi (ANSI)	H1C
-30Hg...600 psi (ANSI)	H1L
0...100 psi (ANSI)	H21
0...160 psi (ANSI)	H22
0...200 psi (ANSI)	H23
0...300 psi (ANSI)	H25
-30HG...60 psi (ANSI)	H2C
-30HG...0 psi (ANSI)	H59
-30HG...15 psi (ANSI)	H73
-30HG...30 psi (ANSI)	H75
-30HG...100 psi (ANSI)	H78
-30HG...150 psi (ANSI)	H79
-30HG...220 psi (ANSI)	H81
-30HG...300 psi (ANSI)	H82

### Kind of pressure

Relative (gauged)	R
Absolute	A

### Electrical Connection

M12-A, 5-pin with shielded cable, length: 2 m	0604
M12-A, 5-pin with shielded cable, length: 5 m	0605
M12-A, 5-pin with shielded cable, length: 10 m	0606

**Ordering information**

**Ordering key - Configuration possibilities see website**

YTED - ## . 5 . ### . # #### 2037

**Display orientation**

300° directional display

2037