

## O300.GP-PV1T.72N

Diffuse sensors with background suppression - miniature

Article number: 11110441

### overview

- background suppression
- 30 ... 200 mm
- pulsed PinPoint LED
- PNP complementary
- qTeach
- connector M8 4 pin
- -25 ... 60 °C
- IP 67



### Technical data

#### general data

type	background suppression
light source	pulsed PinPoint LED
sensing distance Tw	30 ... 200 mm
sensing range Tb	15 ... 200 mm
power on indication	LED green
light indicator	LED yellow
sensing distance adjustment	qTeach
wave length	630 nm
suppression of reciprocal influence	yes
alignment optical axis	< 2°

#### electrical data

response time / release time	< 0,49 ms
voltage supply range +Vs	10 ... 30 VDC
current consumption max. (no load)	45 mA
current consumption typ.	30 mA

#### remarks

- qTeach

#### electrical data

voltage drop Vd	< 3 VDC
output function	light / dark operate
output circuit	PNP complementary
output current	< 100 mA
short circuit protection	yes
reverse polarity protection	yes

#### mechanical data

width / diameter	12,9 mm
height / length	32,3 mm
depth	23 mm
type	rectangular
housing material	plastic (ASA, PMMA)
front (optics)	PMMA
connection types	connector M8 4 pin

#### ambient conditions

operating temperature	-25 ... +60 °C
protection class	IP 67

# O300.GP-PV1T.72N

Diffuse sensors with background suppression - miniature

Article number: 11110441

## dimension drawing

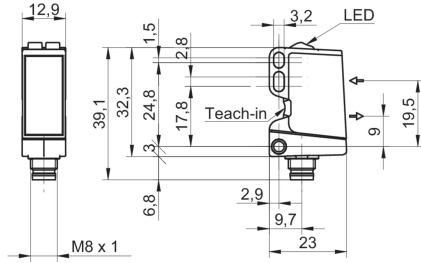

## sensing distance diagram

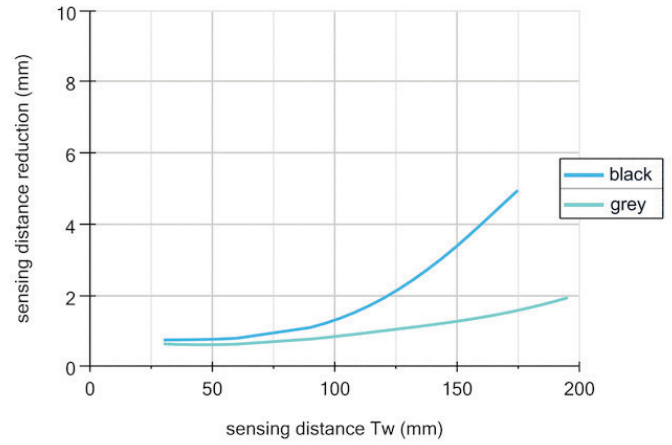

## connection diagram

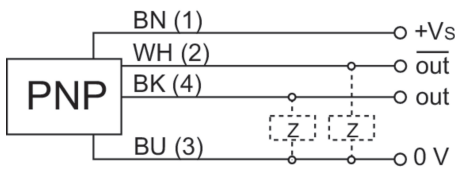

## pin assignment

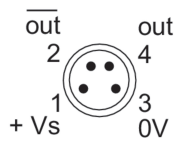

## beam characteristic (typically)

