

### Aerodynamic LED Light Bar Suitable for High Speed Emergency Vehicles

- Slim design
- Vivid & powerful signal



#### Common Specifications

- Compact and aerodynamic design minimizes air resistance in high speed vehicles
- Transparent polycarbonate outer and inner lens provides clear signal light transmission
- Strong mechanical strength, heat, and UV light resistance
- Excellent protection from vibration and impact with use of aluminum boards for both the top and bottom plates
- Internal heat discharges naturally because each LED module adopts an excellent heat dissipative structure
- QLV-SET includes amplifier that has a built-in one-touch switch for selection between signal sound and warning light
- QLV-SET includes a 100W high volume horn with clear warning sounds
- 1,250mm, 1,150mm and 885mm length models are also available
- Lens color : ●Blue-Red ●●Red-Red ●●Amber-Amber ●●Green-Green
- Available in customized color arrangements
- Materials  
QLV Light Bar Model : Lens-PC, Cover-AI, Board-AI, Mount bracket-STs
- QLV-SET : QLV Light Bar Model-PC other/ SAMP-100-Steel, AI/ SM-100ND-Steel
- Ambient operating temperature : -30°C to +50°C
- Protection rating : IP56

#### Product Features

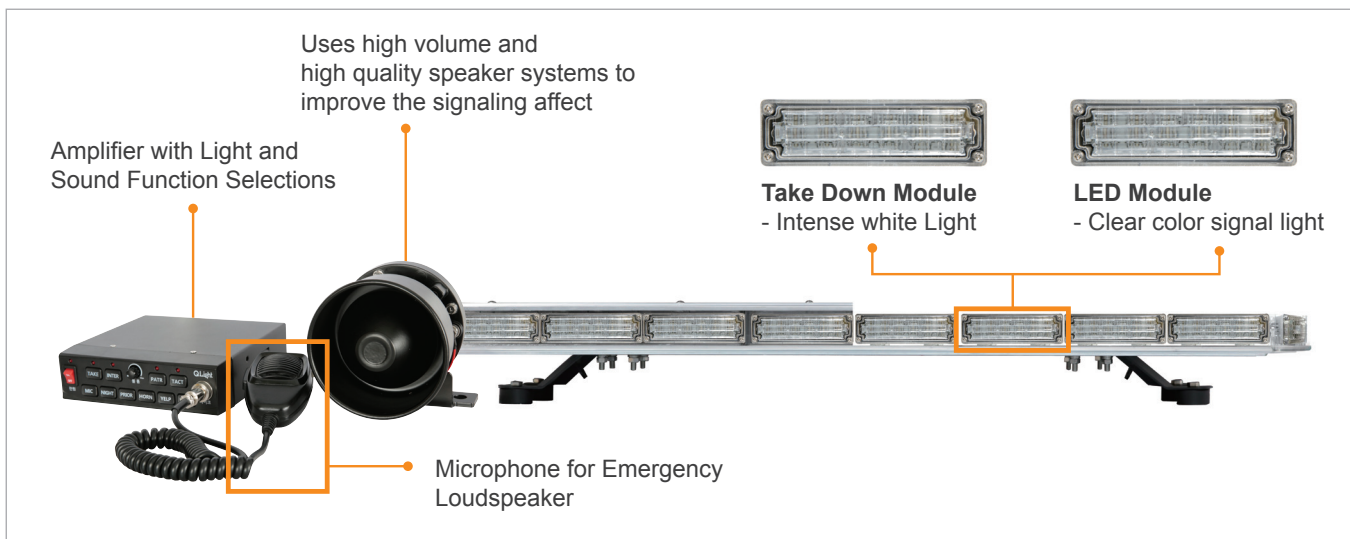

# QLV series

## Controllable AMP for Warning Light Bars

### Recommended Amplifier Designed for QLV Warning Light Bar



SAMP-100

### SAMP-100 Controllable AMP for QLV Warning Light Bar

- Simple linkage between sound signal and warning lights
- Clear and stable sound signal
- Built-in switch for emergency voice on the microphone
- Amplifier is already part of QLV-SET model



#### Specifications

Model number	Voltage	Current	Sound pattern	Frequency/ Repeat time	Certificate	Weight
QLV-AMP	DC12V	10A	Fire Alarm	300~700Hz/140cycle	-	1.15kg
			Emergency	350~750Hz/14cycle		
			Horn	600Hz~91KHz		
			Buzzer	2.25Hz/90cycle		



#### Technical Diagram

(Units : mm)

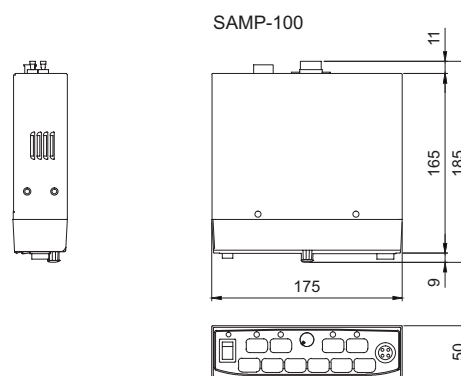

# QLV series

## Horn for Warning Light Bars



### Recommended Horn Designed for QLV Warning Light Bars



SM-100ND

### SM-100ND Horn for QLV Warning Light Bars

- 100W high volume horn with clear warning sounds
- Mounting bracket for applications in various environments



#### Specifications

Model number	Voltage	Volume	Certificate	Weight
SM-100ND	DC12V	Max 135dB	-	1.15kg



#### Technical Diagram

(Units : mm)

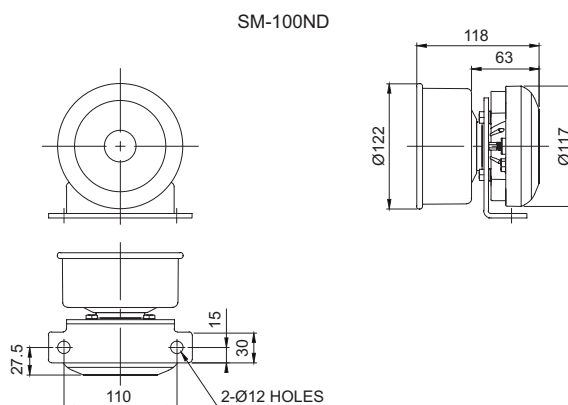

Warning/  
Signal/  
Stackable



Signal &  
Electric Horn/  
Speakers



Vessels and  
Heavy-Duty  
Equipment



Explosion  
Proof



Warning  
Light Bar



Aviation  
Obstruction  
Lights



Signal Tower  
Lights



USB/ETN  
Signal Tower  
Lights



Electric Horn/  
Speakers



Industrial  
LED Lights