

TED

Connectors

Sealing for connectors | FLEXAgraff-SI-ASF

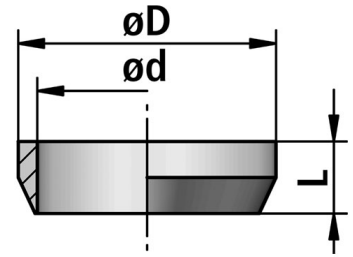

Temperature:	-60°C ... +300°C
Material:	PTFE



FLEXA No.	OD [mm]	ø D [mm]	ø d [mm]	L [mm]	Weight [kg/100]	PU [pcs.]
15030013010	10,0	13,0	10,3	6,0	0,054	50
15030013014	14,0	17,0	14,3	6,0	0,070	50
15030013017	17,0	21,0	17,3	6,0	0,120	50
15030013021	21,0	25,0	21,3	7,0	0,160	50
15030013027	27,0	32,0	27,4	9,5	0,400	25
15030013036	36,0	41,0	36,4	9,5	0,480	25
15030013045	45,0	50,0	45,4	9,5	0,600	20
15030013056	56,0	61,0	56,5	9,5	0,800	10

Recommendations for any areas of applications, products, or product combinations are issued to the best of FLEXA's knowledge and experience. The user is requested to check applicability of FLEXA products to specific applications and purposes prior to the use of the particular products. All documentation, illustrations, and charts published are subject to copyright and must not be copied, changed, used, or modified. Technical drawings, certificates, authorizations, and results by the FLEXA lab will be provided upon request. FLEXA will not be held liable for typographical or other errors and incorrect drawings. Technical modifications are subject to change without prior notice.